

CETOP-05 SIZE MULTI-STATION SUBPLATE WITH PRESSURE CONTROL VALVE



Characteristics

Elements no.	2	3	4	5	6
H	160	240	320	400	480
K	136	216	296	376	456
Weight (Kg.)	12	18.5	25	31.5	38

Description Subplate with CETOP-05 size connections and 3/4" BSP A-B-P and 1" BSP T ports equipped with pressure control valve.

Dimensions

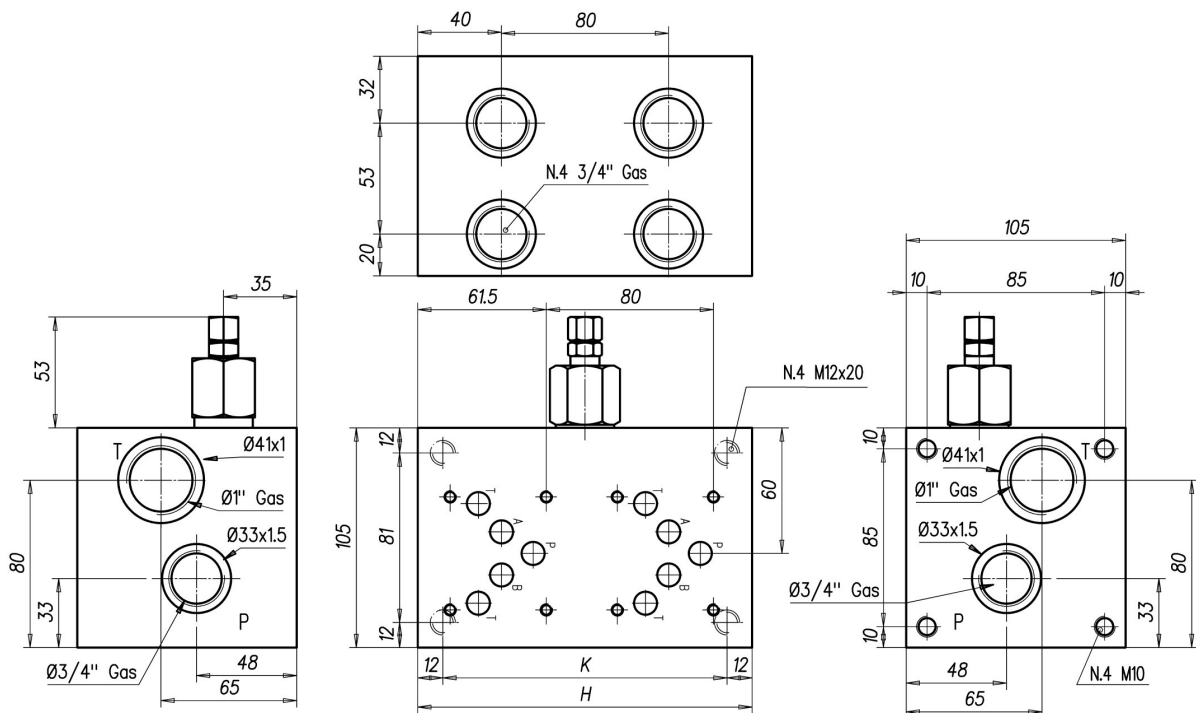

Installation rules

- The subplates type SBM can be mounted in any position
- Fluid to be used: hydraulic oil in compliance with DIN 51524 rules, viscosity between 30 and 100 mm²/s (cSt) at 40°C
- Recommended filtration: 25µ
- Hydraulic fluid temperature: from -20° to +75°C

Ordering code

